

## FOR SAFETY

Followings are the safety instructions & rules. Prior to using the safe, please read the instructions carefully.

### ⚠ Cautions when placing the safe.

- ⊘ The Safe is heavy and must be handled with extreme care.
  - Do not move the safe when the safe is open.
  - Be cautious not to be bumped against corners of safe.
- ⊘ Position the safe door to the front and don't lay or turn safe upside down.
- ⌚ To avoid dampness, place the safe in a well ventilated and flat floor.

### ⚠ Cautions when using the safe.

- ⊘ Keep the Override Key outside of the safe.
- ⊘ Be careful not to close the door roughly.
- ⊘ As the safe is heavy and operated with a smart digital lock, we advise children not to touch it.
- ⊘ Please be cautious of your hands and fingers when closing the door to avoid injuries.
- ⊘ In case of dampness inside the safe, articles may become moldy. Please store your safe box in a cool, dry place.
- ⌚ Be careful not to forget the user code, and keep the instruction outside of the safe.

## 1 Installing Batteries

Before using your safe, please insert batteries. (1.5V AA Batteries 4 pcs)

1. Open the battery case cover on door back of the door.
2. Install batteries in compartment as illustrated. (*SECURE* & *880088* appear on LED display.)

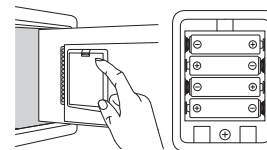

- Even if batteries are completely exhausted, user code never erases.
- When pressing "LOCK" button in closed state, *88888* or *88880* appears on LED display depending on battery power.
- When *88880* appears on LED display, please replace all batteries.

## 2 Setting User Code

Set your user code when safe is in OPEN position.

1. Press "CLEAR-CLEAR" buttons consecutively. (*8888* appears on LED display.)
2. Press "6-8-LOCK" button consecutively. (*888* appears on LED display.)
3. Input new code (3-6 digit) and press "LOCK" button.

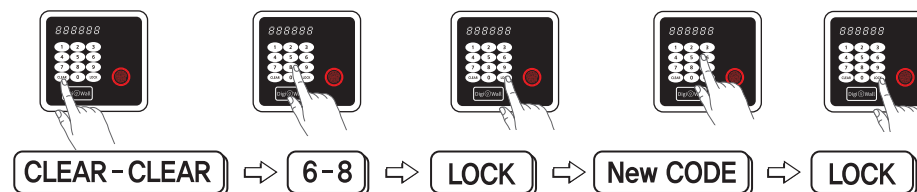

Please check whether your new code was properly registered by opening door with your new code before closing the door.

## 3 Fingerprint Registration

You will be able to program 20 fingerprints,

Register fingerprints when the safe is in OPEN position.

1. Press "CLEAR-CLEAR" buttons consecutively (*8888* appears on LED display.)
2. Press "LOCK" button.
3. The fingerprint scanner will light up to start fingerprint registration process.
4. Put your fingerprint on scanner firmly, and you will hear beep then you can release, repeat 3 times.
5. The display will show "DONE", and follow by the number. Now your fingerprint is registered.

If the display show "ERROR", the registration is not success, please repeat the registration process.

Safe can program up to 20 fingerprints. The screen will show "FULL" when there are 20 registered fingerprints.



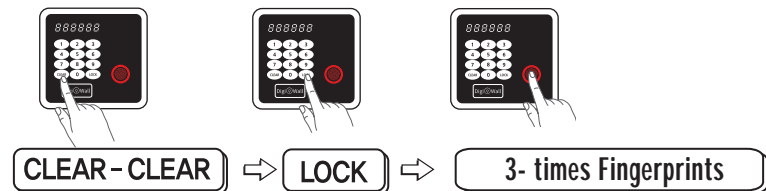

## 4 Delete registered fingerprints

Delete fingerprints when the safe is open.

1. Press "CLEAR-CLEAR " buttons consecutively ( **EEEE** appears on LED display.)
2. Press "7-6-3-LOCK" button. ( **EEEE** appears on LED display.)
3. All the registered fingerprints are deleted.

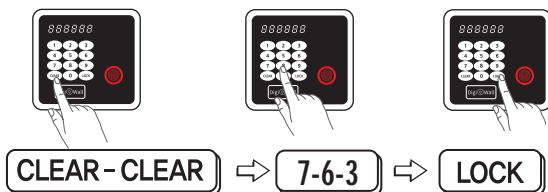

## 5 Safe unlock mode

Note: Default unlock mode is mode 1

- a) Mode 1: Enable password or fingerprint to unlock the safe
- 1) press "Clear-Clear-1-Lock" ( **EEEE** appears on LED display.)

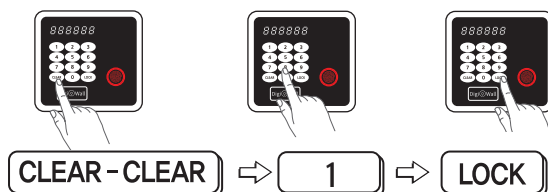

- b) model 2: Enable user code + fingerprint to unlock the safe.
- 1) press "Clear-Clear-2-Lock" ( **EEEE** appears on LED display.)

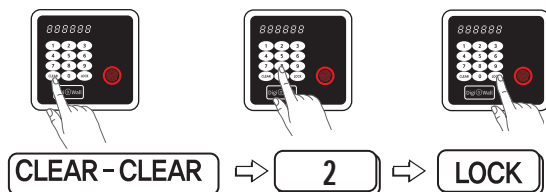

## 6 Opening Safe

1. Input your pincode or fingerprint.
  2. Open the door. ( **OPENED** appears on LED display.)
- If you input wrong code, **EEEE** appears on LED display.
  - If wrong codes tried over 4 times, lock gets paralyzed for 15 minutes. **HHHHH**
  - If **EEEEEE** appears on LED display, input your code again with keeping door closed.

## 7 Closing Safe

1. Keeping door closed, Press " LOCK" button or put the fingerprints on the scanner.
  2. Safe closes. ( **CLOSED** appears on LED display.)
- If **EEEEEE** appears on LED display, press "LOCK" button again while keeping door closed.

## 8 Opening safe with override key

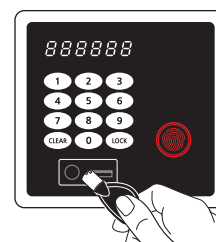

If you forget your code or batteries are low, you may open your safe Using override key.

1. Open the LOGO cover up.
  2. Insert key and turn clockwise.
- Turn key counterclockwise and take it out.
  - Please keep override key apart from your safe.

## 9 Securing Safe on Floor or Wall

1. Place safe where you want to secure it and mark securing hole to drill.
2. Make hole with drill by  $\Phi 3$  wooden floor/wall or  $\Phi 6.5$  on concrete floor/wall.
3. Place safe at right position and secure it using screw and washer. (On concrete floor/wall, insert plastic expanding sleeves into the drilled holes)

