

KEY STORAGE

With secure key storage there is no need to place keys in an unprotected spot like under the door mat or plant pot.

5426D HIGH SECURITY PUSH BUTTON KEY STORAGE UNIT

- Supplied with 4 fixing screws
- Ideal for use in commercial and domestic applications
- Sold Secure & SBD approved
- Large enough for bunches of key, credit cards etc.. 140cm³ capacity
- Solid Zinc body to resist against hammering or sawing
- Weather resistant – suitable for outdoor use. Waterproof cover included
- Up to 16,000 possible codes can be set
- Prevents being “locked out”
- Easily mounts to most surfaces (Fixings provided)
- Can also be used as a mini safe for small amounts of cash & valuables
- Removable weather cover for durability and added discretion when not in use
- Limited Lifetime Warranty

SKU: 5426D



ADDITIONAL INFORMATION

Weight	2.400 kg
Dimensions	173 (H) x 103 (W) x 75 (D) mm
Internal Height	130mm
Internal Width	66mm
Internal Depth	22mm

MASTER LOCK 5426EURD PUSH BUTTON KEY LOCK BOX IMAGES



5426EURD_MAIN



5426D High Security Key Safe



5426D High Security Key Safe



5426EURD_DIMENSIONS

MASTER LOCK 5426EURD PUSH BUTTON KEY LOCK BOX IMAGES



5426EURD_APPLICATION



5426EURD_SECUREDDDESIGN

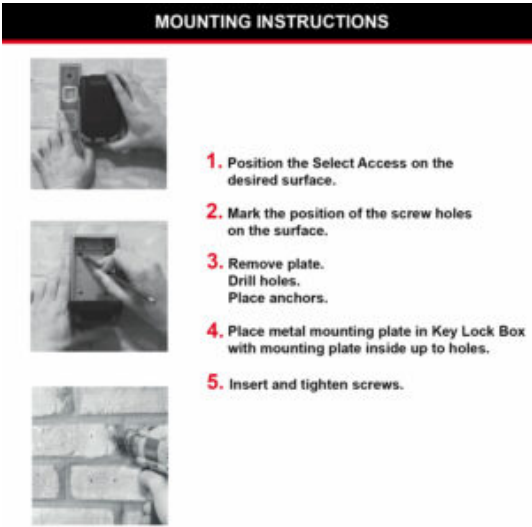

5426EURD_MOUNTING_INSTRUCTIONS

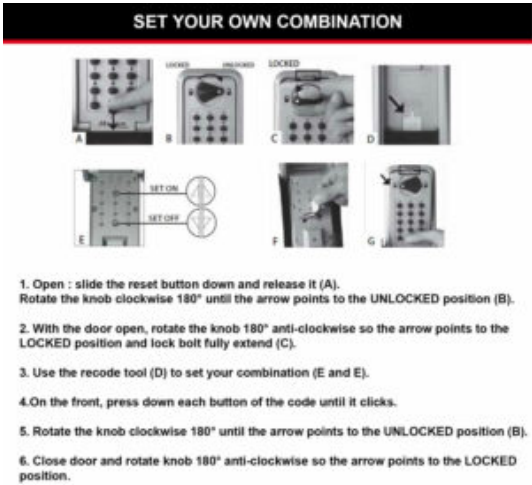

5426EURD_COMBINATIONSETUP

MASTER LOCK 5426EURD PUSH BUTTON KEY LOCK BOX IMAGES



5426EURD_OUTDOOR_WALLMOUNTED



5426EURD_YESNO



Sold Secure Tested



SBD Police Security Initiative

Your Securikey Stockist

Every effort has been made to ensure that the information in this brochure is correct. We have a policy of continually developing and improving our products and reserve the right to change specification without notice. By virtue of the Trades Description Act 1968 all measurements and weights must be considered approximate.

